

# Maisondada.

## SUMO

ARMCHAIR - 2020

Design by THOMAS DARIEL

Sumo armchair is an obvious nod to the Japanese modern martial art and full-contact wrestling form that is Sumo. Only practiced professionally in Japan, Sumo encompasses the quintessence of traditions, identity and strength.



### MATERIALS & FINISHES

#### PRODUCT NO

#### UPHOLSTERY

#### MATERIALS

FUR-SUMO-ARM

#### CATEGORY A

Kvadrat - Gentle Collection - All Colors

#### CATEGORY B

Kvadrat - Uniform Melange Collection - All Colors

Kvadrat - Planum Collection - All Colors

\* COM Fabric available

- Structure in solid timber and plywood.
- Memory foam base.
- Seating and feet fully upholstered in fabric.
- Recommended fabric : Febrik Uniform Melange Collection from Kvadrat.

### DIMENSIONS & WEIGHT

#### PRODUCT

#### PACKAGING

HEIGHT

80 cm

84 cm

WIDTH

113 cm

117 cm

DEPTH

80 cm

84 cm

SEAT HEIGHT

45 cm

WEIGHT

30 kg (net)

35 kg (gross)

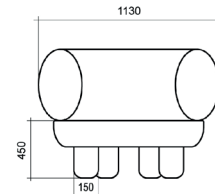
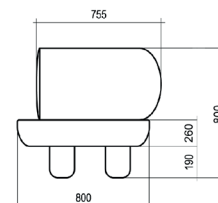
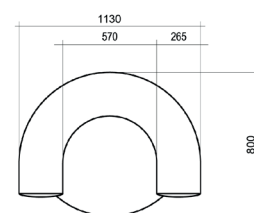

### OTHERS DETAILS

#### MAINTENANCE

- Do not use strong cleaning agents or abrasives.
- Avoid placing the furniture near direct sunlight, heater, cooling vents or moon.
- Clean with a soft damp cloth.

- For more fabric instructions : <https://kvadrat.dk/care-and-maintenance>

#### SAFETY

Do not stand or step on the furniture.

For more information : [www.maisondada.com](http://www.maisondada.com)